

# FUTURES RISING

## Fifty Years of Growth

In 1967, community colleges were a relatively new phenomenon in America. At the time, little was known about the critical role that community colleges would come to play as the provider of the first two years of a bachelor's degree, as well as educator to much of their respective communities' workforce. Yet Lake County residents saw the possibilities and resoundingly approved the creation of Lakeland Community College through a vote of the people and both public and private investments that year. Our early leaders and supporters hoped that enrollment would someday in the distant future reach 3,000 students annually.

Today, Lakeland serves more than 12,800 students annually and provides a continuum of education, from college credit courses for high school students, to certificates and associate degrees, and recently to bachelor's, master's and doctoral programs

at the Holden University Center, a pioneering hub for advanced degrees that was enthusiastically supported by private and public dollars. Lakeland is indeed educating much of the workforce of Lake County as well as citizens from surrounding counties. Futures are rising and lives are transforming.



# The Region's **Leader** in Driving Student Success *Ready to Go Even Further*

Lakeland students come from across our region and are as diverse as our region itself. Our students are the high achievers in high school, and they are the students with daunting learning challenges. They are the 18-year-olds entering directly from high school, as well as the students from every age bracket beyond young adult. They represent the highest socio-economic segments in our community, and the lowest. They are native English speakers, and they are also the students learning English as their second, third or fourth language. Throughout these first 50 years at Lakeland, our administration, faculty and staff have learned a great deal about this rich, melting pot that is the Lakeland student body. And, we have particularly learned of the unique challenges that face many of our students, challenges which often prevent them from pursuing their college educations, or finishing once they have begun.

Each year, a substantial number of students arrive on our campus requiring some form of academic remediation. In fact, over the past three academic years, over half of all students arriving at Lakeland required this help to catch up before they could even get started. But college readiness is just one hurdle facing many of our students. Intellectual, physical and emotional baggage can be impactful on the ability of students to succeed, and often this baggage is tied to low socio-economic circumstances. As a community college with open admission, Lakeland serves a disproportionate number of low socio-economic status students. For these students, the challenges facing them are compounding and pervasive.

Recent research shows that students coming from low socio-economic status families are more likely to have:

- parents with less education.
- lower family income.
- the need to work to support themselves or their family.
- children of their own at home.
- lower cognitive development.
- higher levels of toxic stress.
- higher levels of health issues.

Lakeland is the region's educational institution with the most effective response to our students' unique needs and to our community's workforce priorities. But we can do even more.

The realities in our students' lives can have a significant impact on their ability to succeed in college. Recognizing this, Lakeland's administration, faculty and staff have worked to better understand the impact of these life experiences and change our campus and classroom approaches accordingly. Much of our work over the last decade has been in piloting these new approaches for teaching and for structuring our learning environments.

- **83%**  
OF GRADUATES SAY THEY COMPLETELY ACCOMPLISHED THEIR GOALS AT LAKELAND
- **98%**  
OF GRADUATES ARE VERY SATISFIED/SATISFIED WITH THEIR EDUCATIONAL EXPERIENCE AT LAKELAND
- **40%**  
RECEIVE FINANCIAL AID OR PELL GRANT
- **68%**  
PART-TIME STUDENTS
- **97%**  
OF LAKELAND GRADUATES LIVE OR WORK IN OUR COMMUNITY

26

AVERAGE AGE  
OF STUDENTS



STUDENTS EARN  
AN AVERAGE OF  
**\$32,200-  
\$55,000**  
IN FIRST YEAR  
AFTER GRADUATION

We are crafting support structures and other means to level the playing field so our students have every opportunity to succeed. We are making technology and research tools available 24 hours daily to our students, as well as support services for our students' responsibilities outside of the classroom, such as raising children and caring for aging family members. Our faculty members are differentiating instruction to meet the needs of individual learners.

Through this experimentation, we have seen success at the individual and small group levels, and we are meeting students wherever they are on their educational journey.

Futures are indeed rising. Our students earn an average of \$32,200-\$55,000 in the first year after graduation. And, our community is benefitting as well with many of the jobs in Lake County filled by Lakeland graduates. Across our Northeast Ohio region, Lakeland graduates have a significant impact on the regional economy.

**There are tangible successes happening each and every day in our students' lives and in our community.**

Lives are being transformed. Our community's businesses are increasing their competitiveness. And behind it all is Lakeland, committed, steady and laser-focused on student success. It is time to scale our efforts across campus and have an even greater impact on our students.



**12,800+**  
STUDENTS  
ANNUALLY



**21%**  
ARE MINORITY  
STUDENTS

**PLANNED ENHANCEMENTS  
ACROSS CAMPUS**

**HIGH-TECH  
CLASSROOMS**

**CREATIVE SPACES  
FOR INTERACTION**

**ACTIVE LEARNING  
ENVIRONMENTS**

**NEW DEGREES IN  
HIGH-DEMAND  
FIELDS**

**NEW STUDENT  
SUPPORT CENTER**





# A Bold, New **Plan** Underway

Today, we are intent on actively creating a campus experience that enhances and dramatically increases student achievement.

Our efforts are guided by a Master Plan for Student Success, which brings bold, innovative direction to our program design, degree offerings, facilities construction, building renovations, immersive student experiences, student services and community partnerships.

The plan's definitions of student success are ambitious as well, including higher achievement in individual courses, increased attainment of degrees and pursuit of workforce opportunities our students never imagined possible before.

Aspects of our Master Plan for Student Success include:

- a robust tutoring program for students in need of academic remediation.
- life transition counseling for veterans entering or returning to college.
- college credit courses for high school students to give them an early advantage.
- expanded financial aid counseling and a growing pool of available scholarship funds.
- a newly created office of alumni affairs to keep Lakeland graduates connected, networking and learning through their lifetimes.
- programs based on design-thinking.
- new degree programs, in high demand in the economy including 10 new healthcare majors.
- programs and experiences that immerse students in campus life.
- a variety of new support services.

A key component and one of the first embodiments of our Master Plan for Student Success is our facilities and grounds plan. It will be completed in phases. Each phase will offer physical enhancements to the student experience that will strengthen the opportunities for learning to take place throughout our campus environment, encourage cross-curricular interactions and conversations, and more closely mirror the workplace experiences our students will immediately step into so they have a significant edge for employment. Simultaneously, our facilities and grounds plan addresses long-standing infrastructure issues across campus, which was designed for a fraction of the more than 12,800 students served annually.

## MASTER PLAN FOR STUDENT SUCCESS

- **TUTORING**  
FOR ACADEMIC REMEDIATION
- **COUNSELING**  
FOR TRANSITIONING VETERANS
- **COLLEGE CREDIT**  
FOR HIGH SCHOOL STUDENTS
- **FINANCIAL AID**  
AND ADDITIONAL SCHOLARSHIPS
- **CONNECTIONS**  
AFTER GRADUATION

# Enhancements to the student experience include:

Classrooms that resemble today's high-tech workplace to immediately apply learning and fully prepare students for today's careers



Spaces throughout our buildings and grounds that foster creative collisions, where students across disciplines mix and engage in conversations and idea generation





# Enhancements to the student experience include:

Active learning environments across our campus that immerse students in the college experience, including nontraditional classrooms



Outdoor learning pavilions, simulations labs and an interactive maker space, called HIVE

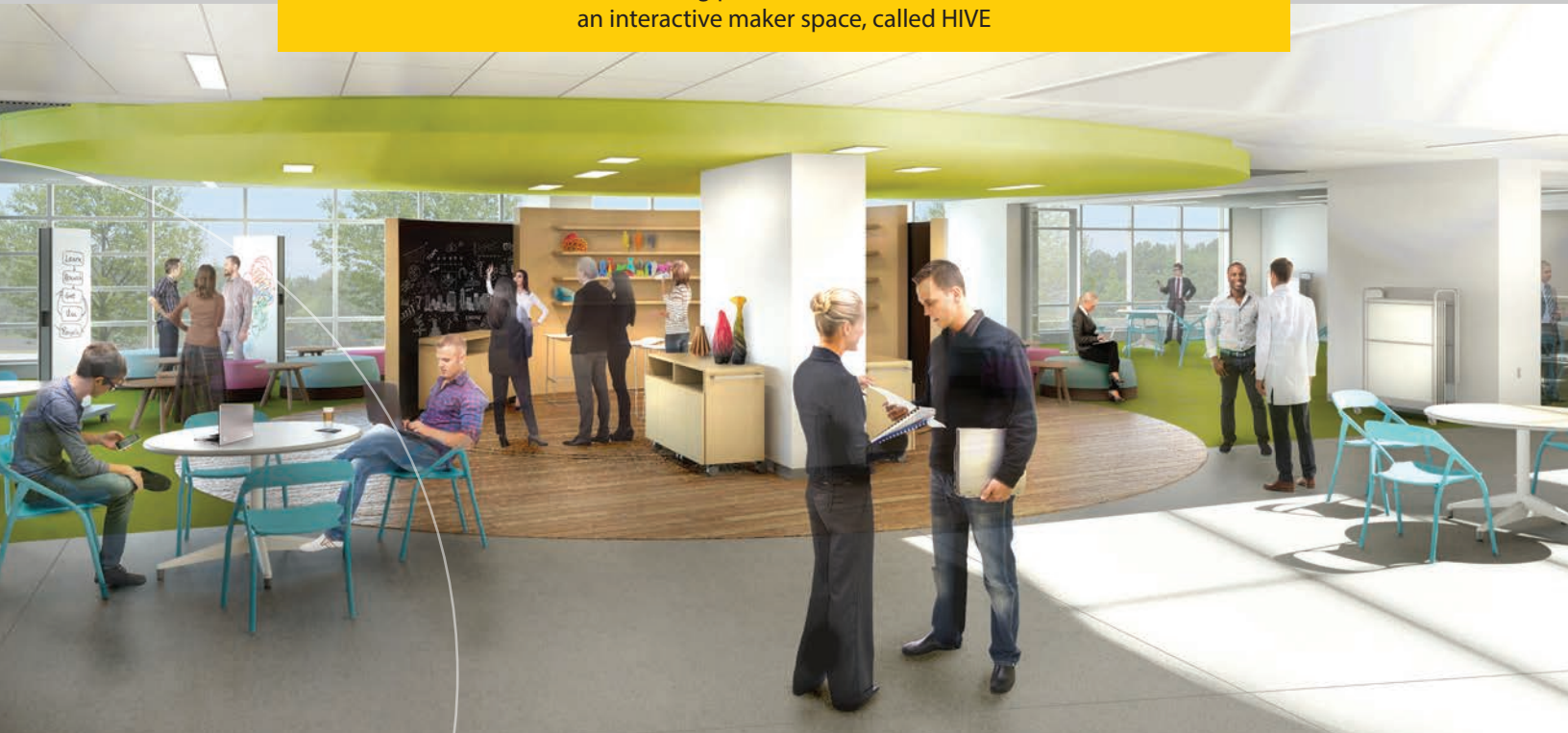



# You Can Be a Part of Our Students' Success Today

The realization of our Master Plan for Student Success is underway, thanks to the collective generosity of taxpayers, community leaders, public partners and regional organizations contributing their resources. Notably, Lake County voters have been a part of our students' success since Lakeland's founding, and most recently through their approval of a \$40 million bond levy that is allowing Lakeland to move aggressively forward on the first phase of the facilities and grounds improvements.

The first phase is funded and construction of a major new building for health and innovation programs is well on its way to completion.

We now ask for your support of Futures Rising by contributing to programs within this building and the emerging programs and support services across our campus that will continue and increase student success.

We are seeking a wide range of gifts through our Futures Rising campaign that is underway, led by The Lakeland Foundation. There are many ways that we can engage you in the overall Master Plan's realization and recognize your generosity.

Thank you for considering a donation to this campaign. As we all celebrate the 50th anniversary of Lakeland this year, and the decades beyond, we continue to be guided by the mission of addressing the needs of our community through education, and by the importance of creating a campus experience that drives success for each and every one of our extraordinary students. We invite you to join us and create many more Futures Rising!



## WE'D LOVE TO TELL YOU MORE!

TO SCHEDULE A TOUR OF OUR CAMPUS, MEET OUR STUDENTS AND FACULTY, AND SEE FIRSTHAND THE LEARNING EXPERIENCES HAPPENING HERE, CONTACT:

**LAURIE PRINCIPE**  
*Campaign Director*

The Lakeland Foundation  
[LPrincipe@lakelandcc.edu](mailto:LPrincipe@lakelandcc.edu)  
440.525.7714  
[www.lakelandcc.edu/FuturesRising](http://www.lakelandcc.edu/FuturesRising)

# FUTURES RISING

OUR CAMPAIGN IS LED BY  
THE LAKELAND FOUNDATION

## CAMPAIGN LEADERSHIP

Dennis Eckart, *Co-Chair, Campaign Committee*

Jason Wuliger, *Co-Chair, Campaign Committee*

Ka-Pi Hoh, *Chair, The Lakeland Foundation*

Bob Cahen, *Executive Director, The Lakeland Foundation*



7700 Clocktower Drive, Kirtland, OH 44094  
440.525.7714

[www.lakelandcc.edu/FuturesRising](http://www.lakelandcc.edu/FuturesRising)