

# Lakeland

COMMUNITY COLLEGE

PROGRAM GUIDE

Applied Studies Division

## Phlebotomy

- Phlebotomy Certificate



Opportunity  
starts **HERE**  
[lakelandcc.edu](http://lakelandcc.edu)

# Phlebotomy



Do you want to work directly with patients? Then a career as a phlebotomy technician (PBT) is a good choice. The laboratory depends on the phlebotomy technician to collect quality samples from the patient to produce quality laboratory results. To do this, the phlebotomy technician must create an atmosphere of trust and confidence with patients while drawing blood specimens in a skillful, safe and reliable manner.

Phlebotomy technicians must set high standards for themselves, and they must be deeply committed to quality health care delivery.

Phlebotomy technicians must like challenge and responsibility. They must also be accurate, work well under pressure, and communicate effectively.

Employment opportunities for phlebotomists are widespread. The growth is driven by the increased medical needs of an aging population, advanced in-home health care services, and expanding employment with contract laboratory organizations.

## Career Opportunities

Employment of phlebotomy is projected to grow 27 percent from 2012 to 2022, much faster than the average for all occupations (Source: U.S. Bureau of Labor Statistics, [bls.gov](http://bls.gov)). Hospitals, diagnostic laboratories and other locations will need phlebotomists to perform blood collection.

## The Lakeland Advantage

- Small class sizes allow for individual instruction.
- Students gain 160 hours of clinical experience.
- Graduates are eligible to take the ASCP Board of Certification PBT exam.

## Lakeland's Program

- Lakeland accepts three phlebotomy classes a year. One in the fall, one in the spring, and one in the summer.
  - In the fall, HLTH 1240 is offered in the evening. (8 weeks)
  - In the spring (January class), HLTH 1240 is offered in the evening. (8 weeks)
  - In the summer, HLTH 1240 is offered in the morning. (5 weeks)
- Students should consider the time classes are offered before accepting clinical opportunity.

## The Clinical Practicum

- Clinicals are four days/week, five hours/day for eight weeks during fall and spring semester and four days/week, eight hours/day for five weeks, if taken in the summer semester.
- The majority of the clinical opportunities are in the morning (around 7:30 a.m.). There are a few that start around 1 p.m. Times for clinicals are not flexible. They are firmly dictated by the clinical sites.

## Requirements for the Program

- Physical form including immunization documentation
- Current Basic Life Support (BLS) certification
- Proof of health insurance
- Criminal background check
- Drug screen

Please contact Paula Pastor-Hinkel at 440.525.7009 with health requirement questions.

## Phlebotomy Certificate/Area of Specialization (3601)

This certificate/area of specialization provides students with the skill and knowledge to collect blood samples by venipuncture and skin puncture. As vital members of the healthcare team, phlebotomists must be able to collect quality samples from patients, assuring quality laboratory results and conforming to current CDC and OSHA guidelines. Phlebotomists must like challenge and responsibility and be able to communicate effectively with patients, laboratory personnel, and other healthcare professionals. After completion of this program, students are eligible to take a national certification exam.

All students enrolled in a nursing or allied health program/certificate must complete a criminal background check. In accordance with clinical site requirements, students with a criminal record may be ineligible to participate in a clinical course/rotation/practicum. Delays, for any reason, in obtaining background results may cause an interruption in the clinical rotation sequence or inability to complete program requirements. Additional background screening may be required by individual facilities.

Drug testing may be requested in accordance with clinical affiliation requirements and/or for patient/student health and safety.

A minimum GPA of 2.0 and a "C" grade or higher is required in all science and program-specific courses for graduation.

Students must apply for admission to this certificate/area of specialization. Students should contact the program director for details about applying for admission to the program.

Course	Title	Credit Hours
<b>First Semester</b>		
HLTH 1215	Medical Terminology for Health Professions	3
HLTH 1238	Structure, Function, Disease, and Therapeutics of the Human Body	4
HLTH 1400	Customer Service and Healthcare	2
	Credit Hours	9
<b>Second Semester</b>		
<b>1st 8 weeks</b>		
HLTH 1150	Introduction to Electronic Health Records	1
HLTH 1240	Phlebotomy	3
<b>2nd 8 weeks</b>		
HLTH 1260	Phlebotomy Clinical Practicum	2
HLTH 1265	Phlebotomy Seminar	1
	Credit Hours	7
	Total Credit Hours	16

For more information about our graduation rates, the median debt of students who completed the program, and other important information, please view this program's Gainful Employment information (<https://lkn.lakelandcc.edu/go/ge/?g=3601>).

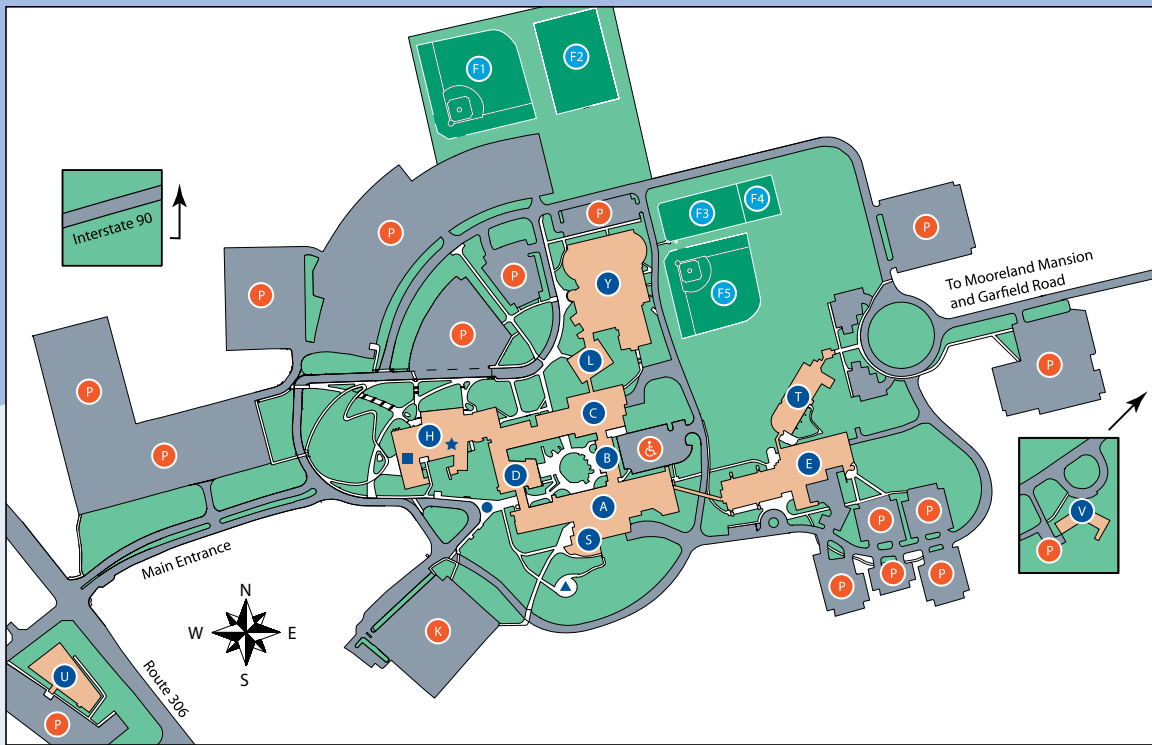

### CAMPUS MAP

**A** A-Building  
**B** B-Building  
**C** C-Building  
**D** D-Building  
**E** E-Building  
**F1** Baseball Field  
**F2** Soccer Field  
**F3** Tennis Courts  
**F4** Multi-Purpose Court

**F5** Softball Field  
**H** H-Building  
**K** Faculty Staff Lot  
**L** Teaching Learning Center  
**P** Parking  
**S** Student Service Center/  
 Breakers Dining  
**T** T-Building  
**U** Holden University Center

**V** Mooreland Mansion  
**Y** Athletic & Fitness Center  
 ● Clocktower  
 ★ Dental Hygiene Clinic  
 ♿ Handicap Parking  
 ■ HIVE  
 ▲ Mind Ladders

### Quality Education

Professors at Lakeland are experts in their fields with real-world experience. Lakeland prepares you for a high-demand career or for transfer to a four-year college or university. Access to bachelor's and graduate degrees is available on campus from partner institutions through Lakeland's Holden University Center ([lakelandcc.edu/uc](http://lakelandcc.edu/uc)).

### Affordable Tuition

Lakeland's tuition is about one-third the cost of most four-year schools. More than 50 percent of Lakeland students receive some form of financial assistance ([lakelandcc.edu/tuition](http://lakelandcc.edu/tuition)).

### Convenience

Lakeland offers convenient day, evening, weekend and online courses ([lakelandcc.edu/schedule](http://lakelandcc.edu/schedule)).

### Focus on Students

Lakeland offers a variety of student services to help you succeed, such as counseling, tutoring, computer labs, career services, free parking and affordable child care.

## Opportunity starts HERE

**Visit** us on campus or online. Call 440.525.7900, email [recruitmentcenter@lakelandcc.edu](mailto:recruitmentcenter@lakelandcc.edu) or visit [lakelandcc.edu/visit](http://lakelandcc.edu/visit) for a campus tour.

**Apply** online: [lakelandcc.edu/apply](http://lakelandcc.edu/apply)

### Accreditation

Lakeland Community College is accredited through the Higher Learning Commission (HLC) and participates in the Academic Quality Improvement Program (AQIP). The Higher Learning Commission, 230 South LaSalle Street, Suite 7-500, Chicago, IL 60604-1413, phone: 800.621.7440, [hlcommission.org](http://hlcommission.org).

**Lakeland**  
COMMUNITY COLLEGE